



Warning:

The product should be assembled by adults.
When using the product, the caregivers must not leave! Keep away from the fire!

Users and guardians should read through the instructions carefully before using this product, and please keep it for future reference. It will tell you the exact operation method and installation procedure to avoid damage or injury to your child's life due to use the product incorrectly.

Babymore
Unit C2, Zenith Industrial Estate, Paycocke Road Basildon, Essex, SS14 3DW.
Telephone: +44 (0)20 3475 5588
Email: customerservices@babymore.co.uk
www.babymore.co.uk

Babymore
more for your baby

Pecan Isofix Base - i Size Car Seat

**Installation and operation instructions
for car child safety seat**

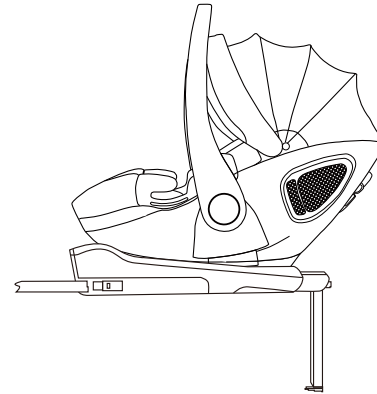

Stature: 40-87CM

Weight: 0 - 13KG

Suitable age: Birth - 15 months



Approved under GB27887-2011 and European ECE R129/03 manufactured in accordance with ISO9001:2015 quality management system standards

Important Notice

The following brief instructions are intended to provide only an overview. In order to achieve maximum security and comfort for your child it is absolutely imperative that you read the whole instruction manual carefully. Order of tasks: set up infant car seat-strap the child in- install infant car seat in the vehicle.

Rearward facing 40-87cm: ISOFIX +Support leg+harness;This is an i-Size Enhanced Child Restraint System.

It is approved according to UN Regulation No.129, for use in, i-Size compatible vehicle seating positions as indicated by vehicle manufacturers in the vehicle users' manual.

If in doubt, consult either the Enhanced Child Restraint System manufacturer or the retailer

NOT TO USE REARWARD FACING ECRS IN SEATING POSITIONS WHERE THERE IS AN ACTIVE FRONTALAIRBAG INSTALLED.

Warning

- 1.This is only suitable if the applicable model is equipped with a three-point, retractor belt as required by ECE R16, Two-point car seat belts are not applicable.
- 2.Ensure that parts of this product are not stuck in car seats or doors when placed and applied.
- 3.Please refer to the instruction manual for how the rigid and plastic parts of the child safety seat should be placed
- 4.Do not use in passenger seats equipped with airbags
- 5.Each webbing of the child restraint device should be fastened, and the webbing that restrains the child should be adjusted to the child's body.(Refer to the instruction manual)
- 6.Ensure that the belt is worn to restrain the pelvic area well, make sure the belt is lowered when worn. The child's pelvis is firmly restrained. (Refer to the instruction manual)
- 7.When subjected to a severe accident, the restraint system should be replaced
- 8.Products without a certified license and modified products are dangerous, and accessories without safety instructions provided by the manufacturer are also dangerous.
- 9.Keep away from direct sunlight, otherwise the surface of the seat will burn your child's skin.
- 10.Please do not leave children alone in a child restraint system unattended
- 11.Baggage and items that are likely to cause injury in a collision should be properly stowed
- 12.Child restraint systems without a cloth cover cannot be used.
- 13.Cloth covers made of other materials not recommended by the manufacturer should not be used, as they affect the overall performance of the child restraint system.
- 14.This product is intended for adult installation and adjustment only.
- 15.Do not use any other force points other than those on the instructions and markings
- 16.Do not attempt to remove the child safety seat's label, which contains important information.

- 17.Keep the instruction manual safe for future reference
- 18.Do not attempt to disassemble the car seat unless instructed in the instructions
- 19.Installation on seats with movable airbags is prohibited unless the manufacturer of the car confirms that they are safe
- 20.Do not use installation methods not shown in this manual, and if in doubt, contact the child safety seat manufacturer or retailer
- 21.Do not modify or attempt to modify the child safety seat
- 22.Always check the car seat and how tight it is before each use
- 23.Before each use, make sure that car seat belts and child seat belts are not twisted
- 24.Car seats should also be secured when not in use. An unsecured car seat can injure other passengers in the event of a crash or sudden stop.
- 25.All occupants in the car should be wearing seat belts, occupants who are not wearing seat belts can injure other occupants in a crash
- 26.Do not let children play with or adjust this safety seat
- 27.Do not let children play with or adjust this safety seat
- 28.Make sure all foldable seats snap into place
- 29.Do not place the car seat on the edge of a raised table or on a soft surface, the car seat could fall and injure the child
- 30.This product is only for use in the car, do not use it outside the car
- 31.Do not lubricate the moving parts of this product in any way, and do not use second-hand car seats from unknown sources.
- 32.Make sure there are no foreign objects in the child's clothing pockets, otherwise the child may be injured in an accident
- 33.Adults should wear seat belts at all times
- 34.Take short breaks during long journeys to keep your children active. Do not allow children to use the safety seat for too long
- 35.This seat cannot be used on a side or rear facing car seat
- 36.Car seats are safer in the back than in the front, according to data.

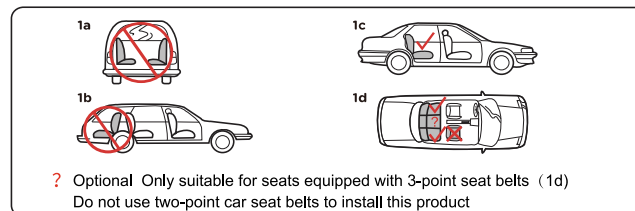

37.Before using the ISOFIX restraint system, please read the instructions on ISOFIX fixing points in the vehicle manufacturer's manual.

38.If the buckle of the adult seat belt interferes with the position of the main force point of the child restraint system, it cannot be used. If in doubt about this, it is recommended to contact the manufacturer of the child restraint system.



Warning

- 1.If you have to drive for a long time, please stop appropriately on the way, otherwise children will be easily fatigued, please always put children in the car child safety seat when the car is driving
- 2.If the child unbuckles the seat belt of the child seat in the car, stop the car in a safe place immediately and re-fasten the seat belt before starting the car
- 3.Do not use a second-hand car seat, it can be dangerous
- 4.Do not leave the security bayonet half-locked
- 5.Make sure the tightness of the child safety seat belt and the position of the safety pad are always in accordance with the instructions
- 6.Every time you use a child safety seat, make sure the car seat belt is tightened and the seat is securely installed
- 7.Do not make any modifications or add parts to the seat, otherwise it may seriously affect its safety performance
- 8.Products without certification and modified products are dangerous
- 9.Please properly place items in the car that may cause injury in a collision accident
- 10.Warning, do not use any other stress points than those described in the instructions

Part Name

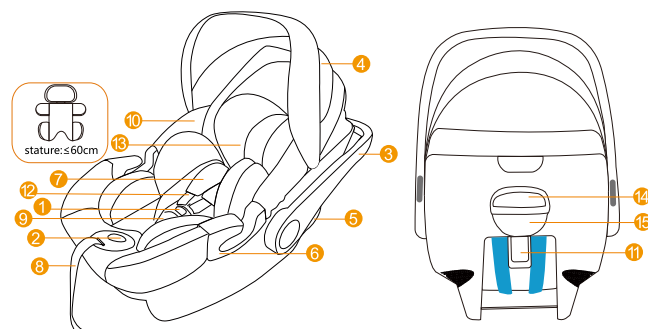

- | | |
|-------------------------------|-------------------------------|
| 1 Buckle | 2 seat belt adjustment button |
| 3 Basket handle | 4 Canopy |
| 5 handle button | 6 seat belt slot |
| 7 shoulder cover | 8 Pull tape |
| 9 crotch protector | 10 Cloth cover |
| 11 headrest adjustment handle | 12 shoulder strap |
| 13 baby cushion | 14 Deck Hook Button |

Part Name _____

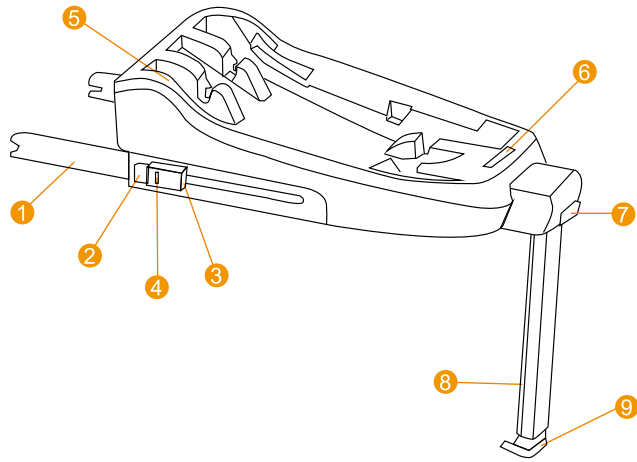

- | | |
|-----------------------------------|---------------------------------------|
| 1 ISOFIX interface | 2 ISOFIX unlock button |
| 3 Second lock button | 4 Fix status prompt |
| 5 ISOFIX adjustment unlock button | 6 base separation handle |
| 7 Support leg extension button | 8 Basket Installation Tips |
| 9 Support leg release button | 10 Tips for using the supporting legs |

Installation of child seat _____

Rearward facing 40-87cm ISOFIX+ Support leg +Y-shaped belt

ISOFIX installation steps

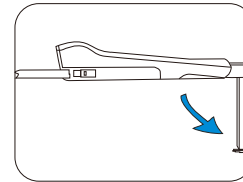

1. Please fully extend the ISOFIX support legs outward

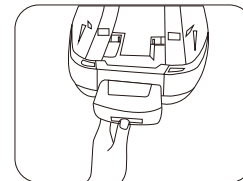

2. Press the support leg extension button and pull the support leg outward until fully extended

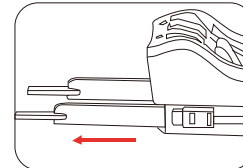

3. Put the ISOFIX base on the car seat, press and hold the ISOFIX unlock button with two fingers at the same time, and push it outward to the outermost side. Fix the ISOFIX interface on the ISOFIX anchor point on the car until you hear the beep.

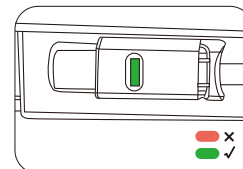

4. When the ISOFIX linker is in the correct installation state, the ISOFIX reset indicator is displayed in green. If the indicator is red, be sure to loosen the connector and reinstall.

Installation of child seat _____

The infant car seat installation steps

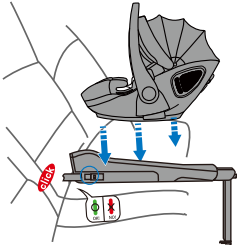

5. When the handle is in the 2nd position, match the supporting car child safety seat with the four installation positions of the ISOFIX base and fix them.

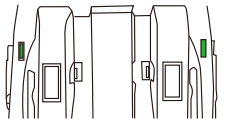

6. When the carrycot seat is installed correctly, the carrycot installation position indicator lights green. If the indicator is red, be sure to loosen the connector and reinstall.

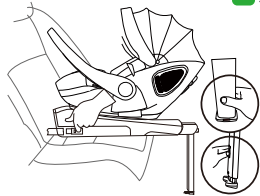

7. Push the ISOFIX base in the direction of the car seat back with both hands at the same time. Make the basket - side against the back of the car seat. And turn the basket handle to gear 3

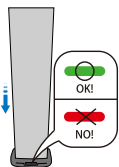

8. Please press and hold the support leg adjuster and adjust the height of the support leg to ensure that the support leg is firmly fixed to the ground without shaking, and then make sure the indicator is green.

Remove the seat from the car _____

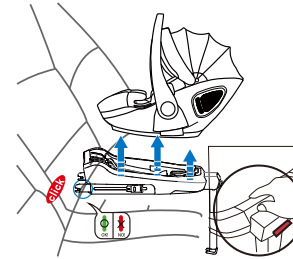

9. Pull the base separation handle, and lift up the handle of the carrier to separate the carrier from the ISOFIX base .

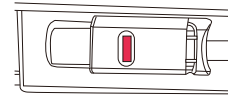

10. Unlock the unlock buttons of the ISOFIX connectors on both sides, hear the prompt sound, and see that the prompt shows red to unlock.

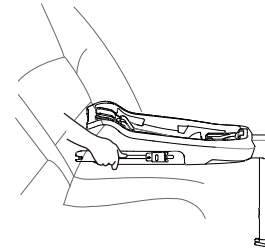

11. Pull the ISOFIX base towards the front of the seat to remove the ISOFIX base from the seat.

The infant car seat use _____



Carry handle can be locked in four different positions (pictured)
 Simultaneously press the red handle buttons on both sides of the handle to rotate the handle back and forth. Rotate to a suitable position, release the handle button, and hear the prompt sound.

Note: After the lock is in place, swing the handle of the basket hard to check whether it is locked.

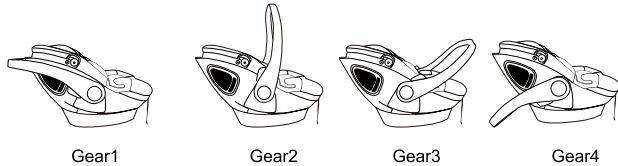

Note: In either case, make sure the baby is buckled up in the car seat and the handles are properly locked.

Ways to immobilize your baby _____

Adjust the height of the straps to make sure they are the right height for your child. The shoulder straps should be adjusted to the height of the child's shoulders or slightly higher.

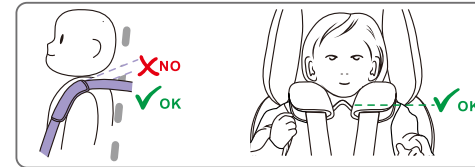

How to Loosen the Shoulder Straps _____



1. Press the adjuster under the front cover of the carrycot
2. While holding the two shoulder straps firmly with one hand, press the seat belt adjustment button with the other hand, and pull the hand holding the shoulder straps towards you to release the shoulder straps.

Adjusting the seat belt height _____

Please adjust the safety belt to the appropriate position for your baby before installing the carrycot safety seat. The seat belt position can be adjusted in 4 positions. Please adjust the seat belt to a position slightly higher than the baby's shoulder when using it.

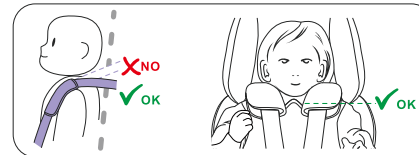

Note: When adjusting the height of the seat belt, the three-point seat belt needs to be loosened.

The infant car seat use

Child Stature : 40- 87cm(applicable age from birth to 15 months)

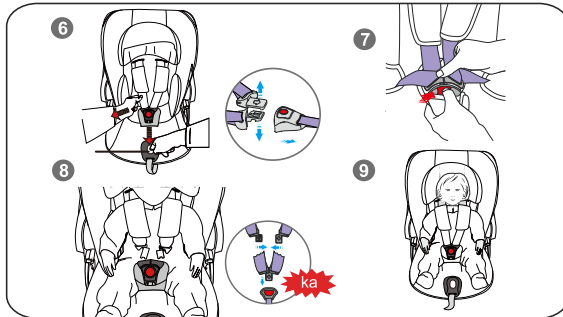

- Press down the seat belt adjustment button and keep pulling up the two seat belts at the same time to adjust to a suitable length (Figure 6)
- Press the red button on the safety bayonet, the insert will automatically pop up a little, pull out the insert and separate it up and down, and place the separated left and right inserts on the left and right sides of the seat (Figure 7)
- Make sure the seat is on a safe surface before placing your baby in the seat (Figure 8)
- Close the left and right inserts up and down, insert the safety buckle, and hear the click.
- Check: Do not press the red button, but pull up the insert, if it does not move, it is installed in place. Pull down the seat belt adjustment belt, and adjust the seat safety belt to an appropriate tightness according to the size of the child. (Figure 9)

Warning: The seat belt of the safety seat plays an important role in the protection of children, and the distance between the seat belt and the baby's body should not exceed the width of one finger. The baby croch pad must be removed when the baby weighs more than 9kg.

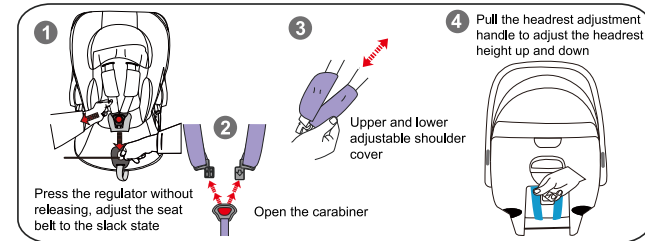

Tips: Make sure that the height of the seat belt is at the same level as the child's shoulder height or slightly higher than the child's shoulder height.

User instructions

Thank you for purchase Babymore Child Seat

The illustrations used in this manual are to illustrate the operation method and product structure of the product. In case of a small difference between the real product and the drawing, the real product shall prevail. In order to improve the quality of the product, we may change part of the structure and appearance of the product without giving notice. Please understand.

Common problems and maintenance in the use of child safety seat

- When you find that the car belt is too short in use, there are the following solutions:
- Please try to use in different seats;
- Adjust the car seat backwards;
- If the seat belt of your car can be adjusted, please adjust it to a lower and proper position.
- Please pull down the slack in the seat belt.
- If you find that the child seat cannot be flat during use; Please try to position the car in different locations.
- Inspect parts regularly for wear or damage. If parts are found damaged, do not use them.

Buckle

- Food, drink or other residue may accumulate in the buckle. Please wash with warm water. When the buckle functions properly, you can hear a sound "click".

Seat belt and plastic pieces

- Wipe with warm water and neutral soap.

User instructions

About the fabric cover

- Do not use the product after removing the fabric cover;
- The fabric cover can be removed and washed, but we do not recommend that you remove it frequently. Once you remove and wash the fabric cover, be sure to reinstall it according to the original structure and make sure that no parts are missing or misinstalled;
- When cleaning the fabric cover, please gently scrub with soap and warm water. Please do not use any detergent, solvent or strong soap.
- Do not remove, move or change any structure or part of the fabric cover or seat belt system of the child safety seat; Do not add any lubricant or other chemicals to the fabric cover or seat belt system; Wash shoulder pads and buckle pad by hand under 40 ° C and lay them flat to dry;
- Do not dry clean, rotary drying, and away from strong light exposure.

Main Content
Cover surface: polyester Filler: polyester Cover inside: polyester
Wash alone, not exceeding 40°C water temperature by hand. Do not bleach, lay flat to dry, do not flip to dry, do not iron, do not dry clean

Precautions for Use

- Please read the instructions of your car carefully before using this product;
- Please keep this manual well for repeated reference;
- This product requires that your car has a three-point traction type seat belt;
- If you have airbags in your car, use them with caution;
- Do not buy second-hand or transfer this type of product;
- Please do not place this product on a high place;

Warranty policy

- To protect your baby from accidental injury, check and maintain the safety seat frequently.
- It is guaranteed for one year. (Warranty basis: purchase certificate and product anti-counterfeit barcode)